

Rehabilitation, Memory Care, Skilled Nursing  
Suite Floor Plan

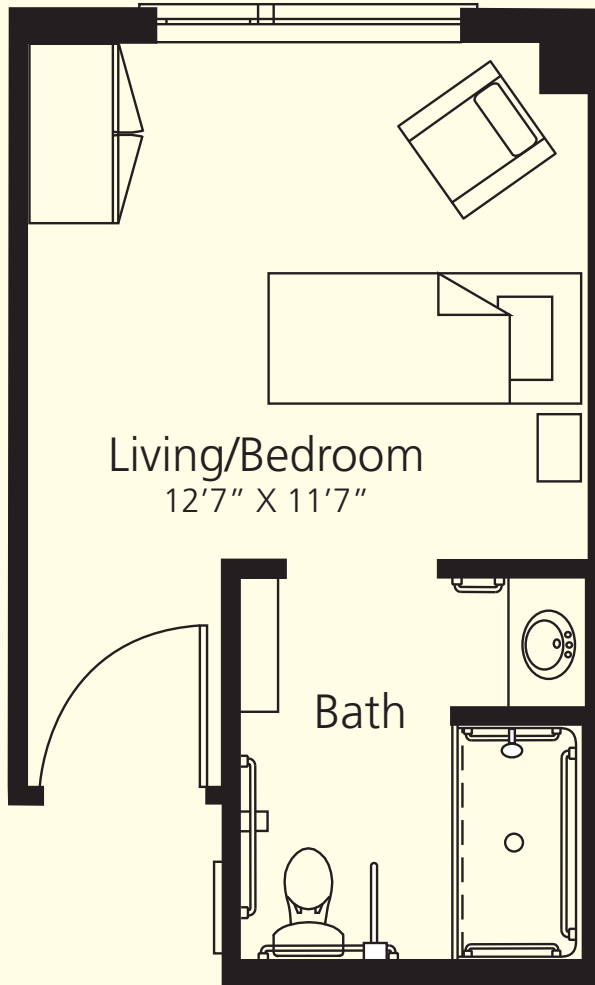

Living/bedroom, private bath  
Approximate size: 239 square feet



*To schedule your personal appointment with Matt Scherr,  
call 970-989-2500 or email: [mscherr@augustanacare.org](mailto:mscherr@augustanacare.org)*



by  AugustanaCare

*Assisted Living · Memory Care · Short-Term Rehab · Long-Term Care*  
(970) 989-2500 | 195 Freestone Road · P.O. Box 5980 · Eagle, CO 81631  
[castlepeakinfo@augustanacare.org](mailto:castlepeakinfo@augustanacare.org) · [www.castlepeak.org](http://www.castlepeak.org)

